



**BRANO a.s, 747 41 Hradec nad Moravicí  
Czech Republic**

tel.:+420/ 553 632 318, 553 632 345

fax:+420/ 553 632 407, 553 632 151

<http://www.brano.cz>

[info@brano.cz](mailto:info@brano.cz)

**OPERATION MANUAL  
SAFETY PRINCIPLES, OPERATION AND MAINTENANCE  
FOR**

**ROPE WITH HOOK**

**Type: Z 500 L**

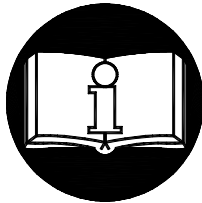
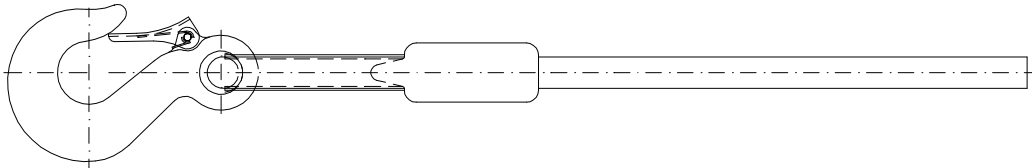

Read carefully this manual before using this product. This manual contains important information on safety, use, operation, maintenance and check of the product. Make this manual available to all responsible persons.

**Keep for further use!**

Edition 1.  
MAY 2006  
Evidence number 1-52473-0-1



# CONTENT

1	DEFINITION .....	3
2	DEVICE PURPOSE .....	3
3	SAFETY PRINCIPLES.....	3
3.1	SAFETY SUMMARY .....	3
3.2	SAFETY PRINCIPLES .....	3
4	PACKING, STORAGE AND MANIPULATION.....	5
4.1	PACKING .....	5
4.2	STORAGE.....	5
5	MAIN TECHNICAL PARAMETERS .....	5
6	USE OF THE ROPE .....	5
6.1	GENERALLY .....	5
6.2	SUSPENDING AND BINDING OF THE ROPE .....	6
6.3	CHECK OF THE ROPE.....	6
6.4	SAFETY WORKING ENVIRONMENT .....	6
6.5	DURABILITY OF THE ROPE .....	6
7	INSPECTION OF THE ROPE.....	6
7.1	INSPECTION .....	6
7.2	ROPE RECORDING .....	7
8	PUTTING OUT OF OPERATION – DISPOSAL.....	7
9	RELATED DOCUMENTATION.....	8
10	FINAL REQUIREMENTS OF THE MANUFACTURER TO THE CUSTOMER .....	8

# 1 DEFINITION

## **! DANGER**

**Danger** is used to indicate the presence of hazard which will cause death or severe injury if the warning is ignored.

## **! WARNING**

**Warning** is used to indicate the presence of a hazard which can cause death or severe injury if the warning is ignored.

## **! CAUTION**

**Caution** is used to indicate the presence of a hazard which can cause minor injury if the warning is ignored. Caution can warn against dangerous practices as well.

**Carrying capacity (Q):** indicates the maximum permitted mass of the load (working load limit), which the rope has been designed for under conditions defined by this operation manual.

# 2 DEVICE PURPOSE

The polyamide rope with the hook (hereinafter referred to as the "rope") is determined for manual lifting and lowering of free loads by means of the bricklayer's pulley of the Z500 type or other applicable pulley under normal climatic conditions in the workplace. Consult any other application with the manufacturer prior to use.

The load weight must not exceed the given permitted carrying capacity of the rope and pulley used as well.

# 3 SAFETY PRINCIPLES

## 3.1 SAFETY SUMMARY

A danger exists when lifting loads, particularly when the rope is not used properly or is poorly maintained. Since an accident or serious injury could result, special safety precautions must be observed in the course of work with the rope and its checking.

Safety principles for the bricklayer's pulley are defined in the separate "Operation Manual" supplied with any pulley.

## **! WARNING**

**NEVER** load rope more than carrying capacity shown on the rope label.

**ALWAYS** work with rope only by man power.

**ALWAYS** read operation manual and safety instructions.

Keep in mind that the operating staff is responsible for proper binding technique, lifting and lowering loads.

## 3.2. SAFETY PRINCIPLES

## **! WARNING**

### **3.2.1 Prior to use**

**ALWAYS** ensure physically fit, qualified and instructed persons older than 18 years of age, familiarized with this manual and trained in safety conditions and way of work, operate the rope.

**ALWAYS** check rope according to the section 7.1 before starting to work.

**ALWAYS** make sure the length of rope is sufficient for intended work.

**ALWAYS** ensure the carrying rope is clean and without defect.

**ALWAYS** use original rope only.

**ALWAYS** ensure the rope is not damaged and is adequately clean.

**NEVER** pull rope by means of the machine drive.

**NEVER** use rope with jumped out or missing pawl of hook.

**NEVER** use rope without label with marking.

**NEVER** use rope damaged by chemicals.

**NEVER** allow the rope come into touch with chemicals.

**ALWAYS** consult use of the rope in non-standard or extreme environment with the manufacturer or his authorized representative.

### **3.2.2 When in use**

**ALWAYS** make sure the load is properly seated in the hook.

**ALWAYS** make sure the hook pawl works in the correct way.

**ALWAYS** pay attention to the limit positions.

**ALWAYS** use man power only.

**NEVER** use mechanically damaged rope.

**NEVER** hitch load on tip of hook.

**NEVER** pull rope over any edge.

**NEVER** expose rope to aggressive environment or excess temperature.

**NEVER** tie other parts for lengthening the rope.

### **3.2.3 Maintenance**

**ALWAYS** enable qualified persons to inspect rope regularly.

**ALWAYS** ensure the rope is clean and undamaged.

## 4 PACKING, STORAGE AND MANIPULATION

### 4.1 PACKING

Ropes are supplied packed in bundle tied by binding band.



### 4.2 STORAGE

Store ropes in dry and clean stocks free of chemical influences and vapours.

(1) Roll up the rope so that it is not twisted.

(2) Lubricate the spring of the hook pawl and contact area of the hook eye with thimble.

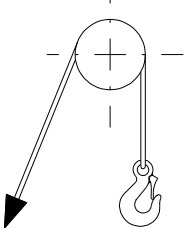
## 5 MAIN TECHNICAL PARAMETERS

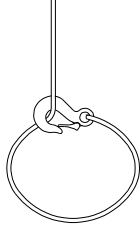
Rope carrying capacity ( according to the binding method )			Safety	Rope diameter r (mm)	Operation temperature range	Rope length (m)	Rope weight (kg/m)
over the pulley	directly	with eye					
			8 : 1	Ø11	-20°C to +50°C	20	0,77
310 kg	310 kg	248 kg					

## 6 USE OF THE ROPE

### 6.1 GENERALLY

The rope is designed for lifting of loads by means of the Z 500 bricklayer's pulley, eventually of other pulley of suitable carrying capacity. Peruse the operation manual for the rope and bricklayer's pulley as well prior to use.

### **! WARNING**

The maximum weight of a lifted load must not exceed the carrying capacity of the rope and used pulley as well.

When using the Z 500 bricklayer's pulley it is necessary to respect the maximum carrying capacity of the pulley, i.e. the maximum load constitute 250 kg (see pic. 6.1).

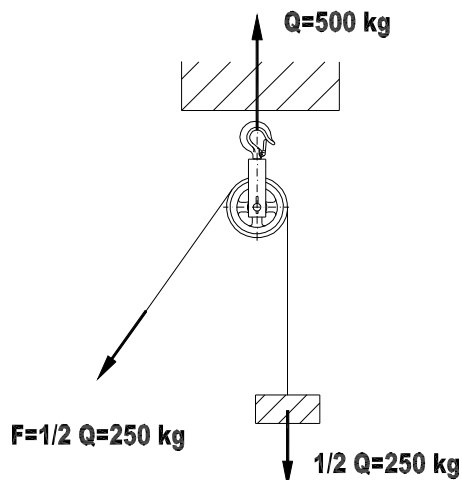

Pic.6.1

## 6.2 SUSPENDING AND BINDING OF THE ROPE

### **! WARNING**

- 6.2.1 On the rope only such subjects can be suspended or tied that by their shape and stiffness enable safety binding.
- 6.2.2 Hook the load or bind it on the eye so that the gravity centre of the load is in the axis of the hook.
- 6.2.3 When binding on the eye the carrying capacity of the rope is reduced by 20%.
- 6.2.4 The free end of the rope must be stretched preventing the rope disentanglement.

## 6.3 CHECK OF THE ROPE

Check whether the rope is not twisted or damaged. Should the rope is twisted turn it back to its correct position. Should the rope is damaged replace it.

### **! CAUTION**

- (1) First see again through the previous articles of this manual and make sure all steps were correctly done.
- (3) Check whether the hook pawl is properly snapped in.

## 6.4 SAFETY WORKING ENVIRONMENT

### **! WARNING**

- (1) The operating staff must be familiarized in detail with this operation manual and national regulations relating to the operation of pulleys used in interaction with the rope.
- (2) In the course of work with the rope the operating staff must be equipped with helmet and gloves.
- (3) When working with the rope in limited areas you must prevent the rope does not rub against obstacle.

## 6.5 DURABILITY OF THE ROPE

The maximum durability of the rope is 5 year from first use. After expiration of this period ropes must be put of use.

However the real lifetime of the rope is given by the frequency and method of use.

# 7 INSPECTION OF THE ROPE

## 7.1 INSPECTION

7.1.1 Keep the rope reasonably clean.

7.1.2 The rope and hook must be:

- a) visually checked before first use in each shift;
- b) checked at least once per:
  - 1 month in metallurgy industry and aggressive environments;
  - 3 months in other operations including uncovered or outdoor ones;
  - 6 months at ropes occasionally used.

- 7.1.3** When inspecting the rope check visually:
- rope marking (marking label with data);
  - overall condition of the rope;
  - wear and tear;
  - change of the rope surface by effect of heat, acids and other chemical substances;
  - condition of eyes and their entangling and condition of cable ends.

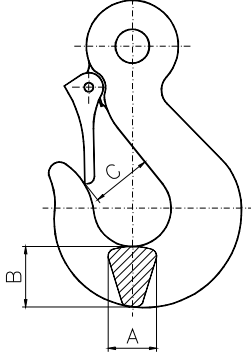
	<b>Hooks with eye – limits for discard</b>					
	carrying capacity (t)	dimension "A" (mm)		dimension "B" (mm)		dimension "C" (mm)
		standard	limit	standard	limit	limit max.
	0,5	14	12,6	20	18	27,5

**7.1.4** The ropes, at which the defects endangering safety, were found out during inspection or checking procedures, must not be used longer and must be professionally repaired or put out of operation.

**7.1.5** Put out of operation the rope in cases as follows:

- a) should the rope is not marked;
- b) after expiry of the defined period from the date of its production;
- c) at reduction of its cross section by 15% and more (i.e. at min.  $\varnothing$  of the rope 9,4mm)
- d) should the eye entanglement is damaged;
- e) when mechanically damaged;
- f) should the change of its surface by the effect of heat takes place.

## **7.2 ROPE RECORDING**

Keep record of the rope. Except for the evidence number and technical data the results of performed checks or eventual repairs of the rope must be recorded.

## **8 PUTTING OUT OF OPERATION – DISPOSAL**

The rope does not contain any harmful substances. After putting it out of operation remove the hook and thimble and give it to a firm dealing with waste disposal.

Send the rope for recycling to the address: Singing Rock  
Poniklá 317  
512 42 Poniklá

## 9 RELATED DOCUMENTATION

EC declaration of conformity

This Operation Manual was elaborated in accordance with following technical regulations, technical standards and national regulations:

- Ministerial order No.24/2003 of the Coll. of Law as amended (EP and Council directive 98/37/EC)
- Ministerial order No.23/2003 of the Coll. of Laws as amended (EP and Council directive 94/9/EC)
- ČSN EN ISO 12100 - 1
- ČSN EN ISO 12100 - 2
- ČSN EN 1050
- ČSN EN 13 157

## 10 FINAL REQUIREMENTS OF THE MANUFACTURER TO THE CUSTOMER

**Any changes of the product can be realized only based on the approval of the manufacturer.**

**When not observing this condition the producer does not guarantee safety of his product. In this case any manufacturer's guarantees do not apply to the product.**